

WINSLOW ADAPTICs

Data Sheet – 2mm Shorting Link W28000G - Open Top W28010G - Closed Top

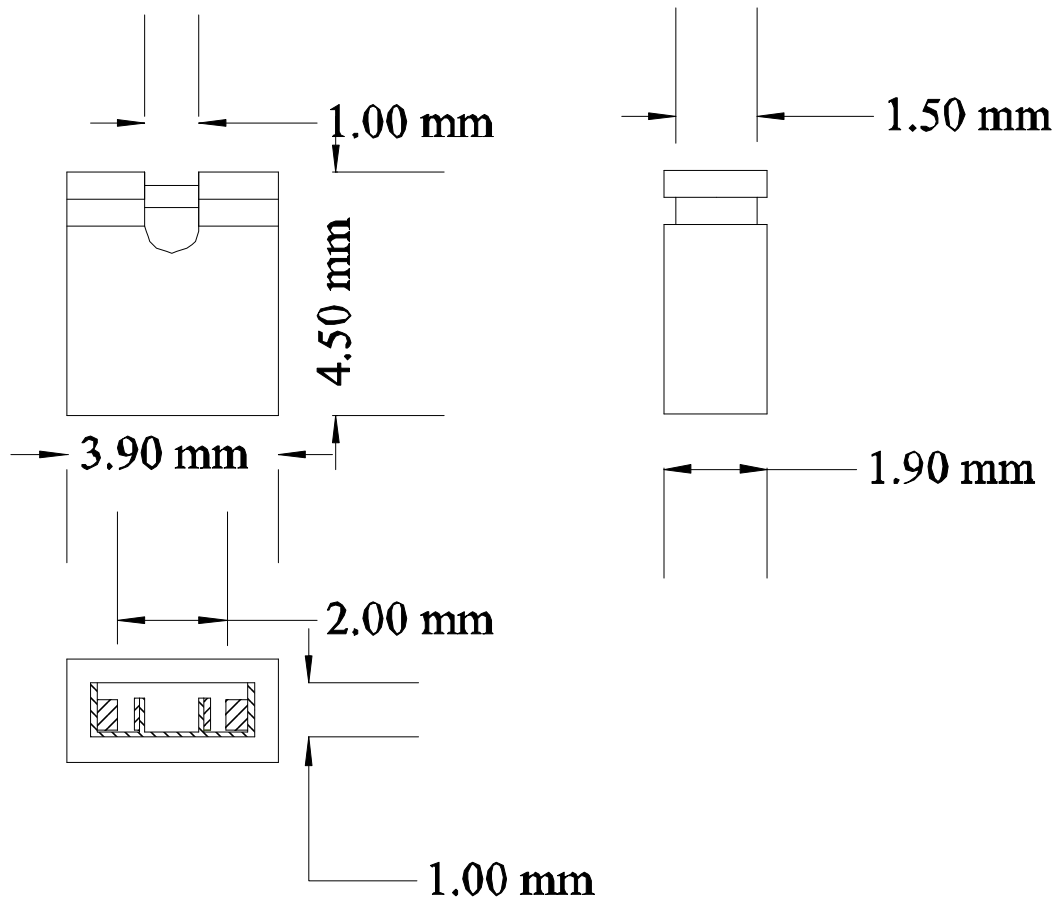

General Specifications. Unless stated all values are typical

Insulator	-	G.F Polyester
Flammability	-	UL94V-0
Contacts	-	Phosphor Bronze
Contact Resistance	-	20mΩ @ 1A DC
Insulation Resistance	-	1000MΩ @ 500V DC
Current Rating	-	3A Max
Temperature Rating	-	-55°C to +125°C